

NOTE;
 * Envirolok Units are Malleable and may be Formed and Filled to Match On-Site Needs

PLAN

This is a typical, non-site specific design. Envirolok LLC makes these documents available on an "as is" basis. All CAD (.dwg) and PDF (.pdf) files were created as a service to our customers. Final determination of the suitability of any information or material for the use contemplated, and its manner of use, is the sole responsibility of the user. A final project specific design should be prepared by a qualified, licensed, professional engineer. THIS DRAWING IS NOT FOR CONSTRUCTION. Copyright 2013, Envirolok LLC

PROJECT ENVIROLOK INSTALLATION; CURVE DIAGRAM	
DATE JANUARY 2013	SCALE 1/2" = 1'-0"
SHEET SHEET 39	

EnvirolokTM
 Vegetated Environmental Solutions

10101 N. Casey Road Evansville, WI 53536
 www.envirolok.com ecosolutions@envirolok.com
 P. 608.223.3571 F. 608.884.4640

REVISIONS

Geogrid Direction of Strength

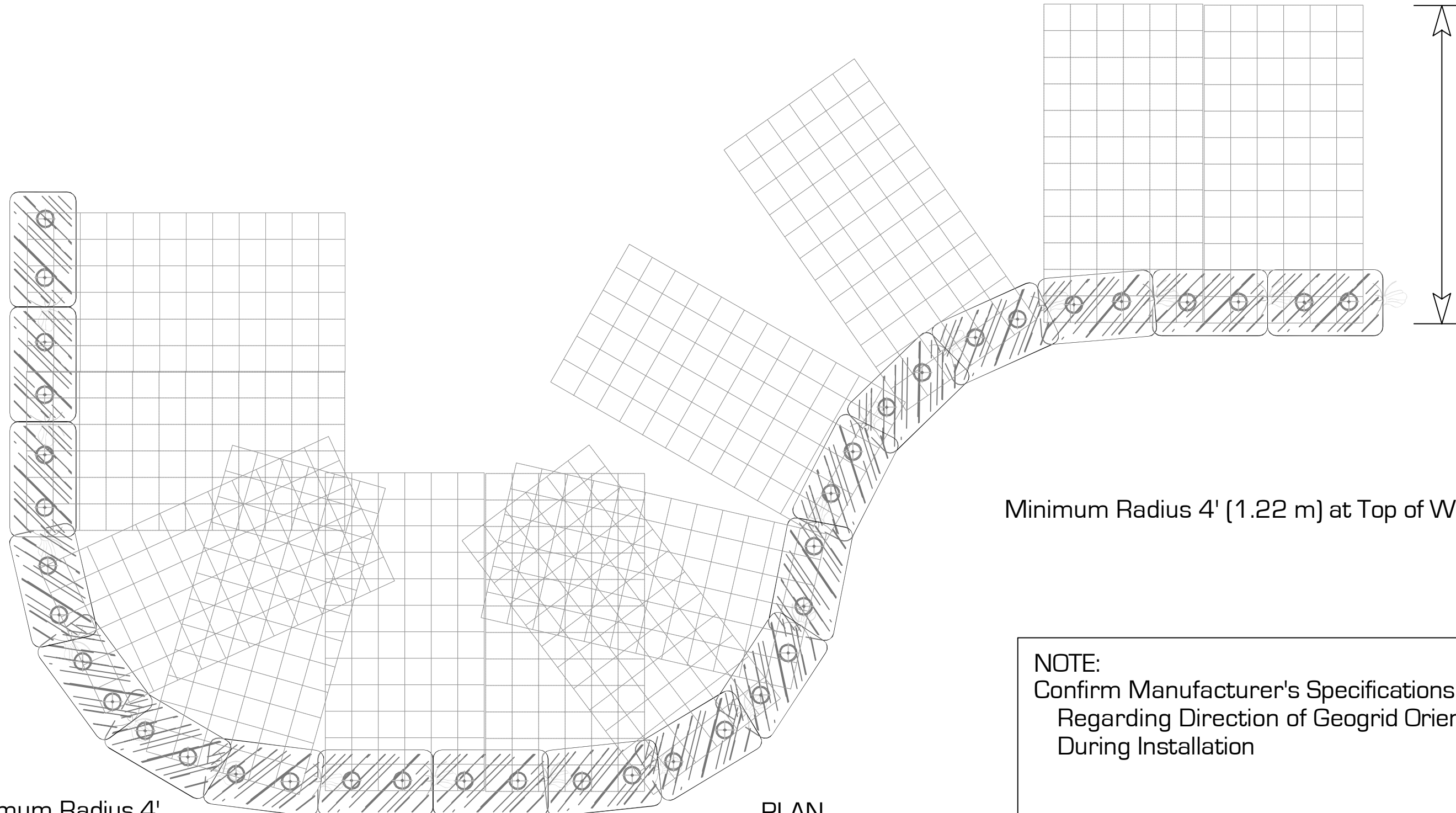

Minimum Radius 4' (1.22 m) at Top of Wall

Minimum Radius 4'
(1.22 m) at Top of Wall

PLAN

NOTE:
Confirm Manufacturer's Specifications
Regarding Direction of Geogrid Orientation
During Installation

This is a typical, non-site specific design. Envirolok LLC makes these documents available on an "as is" basis. All CAD (.dwg) and PDF (.pdf) files were created as a service to our customers. Final determination of the suitability of any information or material for the use contemplated, and its manner of use, is the sole responsibility of the user. A final project specific design should be prepared by a qualified, licensed, professional engineer. THIS DRAWING IS NOT FOR CONSTRUCTION. Copyright 2013, Envirolok LLC

PROJECT ENVIROLOK INSTALLATION; GEOGRID INSTALLATION; CURVED WALL	
DATE JANUARY 2013	SCALE 1/2" = 1'-0"
SHEET SHEET 13	

EnvirolokTM
Vegetated Environmental Solutions

10101 N. Casey Road Evansville, WI 53536
www.envirolok.com ecosolutions@envirolok.com
P. 608.223.3571 F. 608.884.4640

REVISIONS

Alternate Re-inforcement Placement
on Subsequent Re-inforcement Elevations
to Eliminate Gaps on Previous Elevations

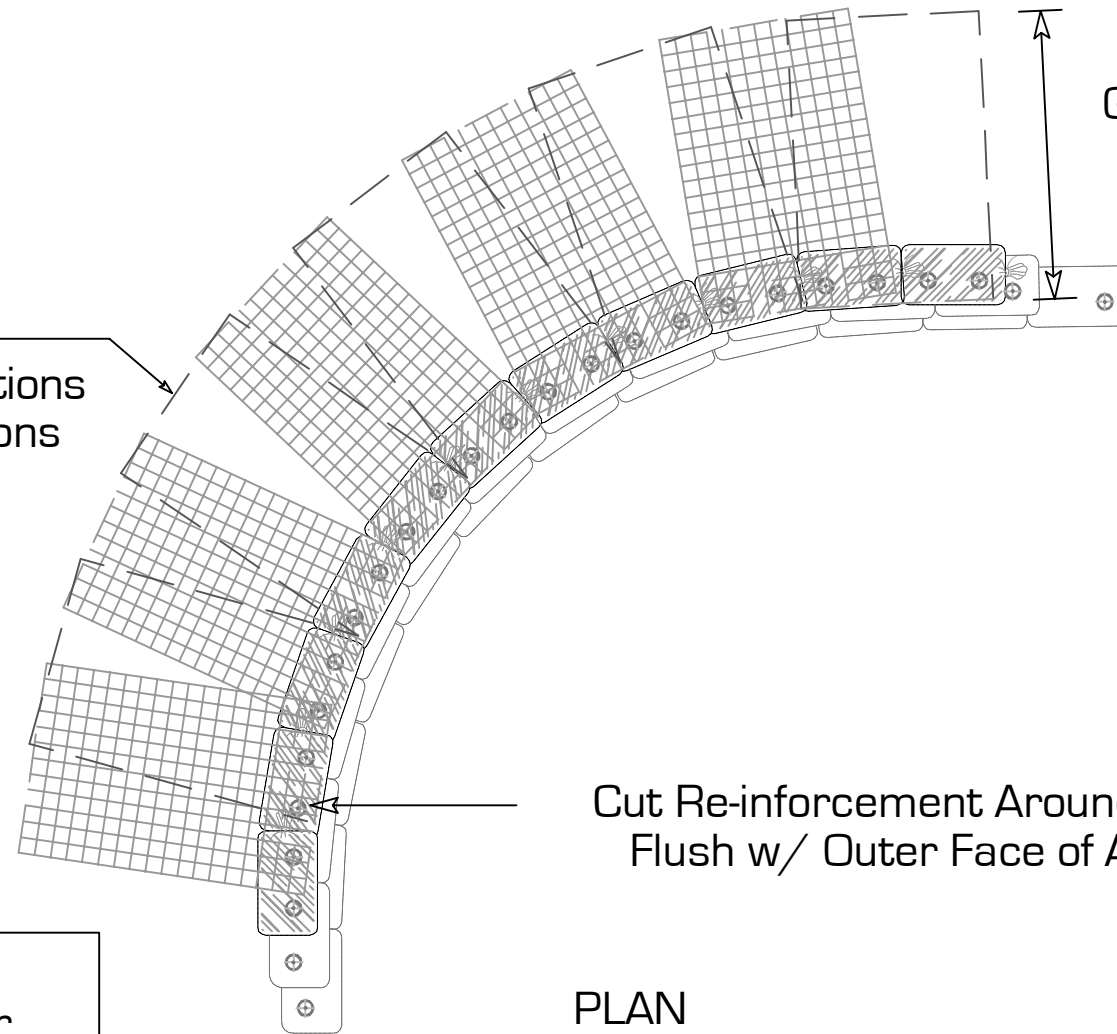

Geogrid Direction of Strength

Cut Re-inforcement Around Radius
Flush w/ Outer Face of Above Unit

PLAN

NOTE;

- * Follow Geogrid Manufacturer's Instructions for Re-inforcement Placement at Curves & Corners
- * Do Not Place Overlapping Geogrid Layers Directly on Top of Each Other.
- * Place and Compact Soil Between Overlapping Re-inforcement

This is a typical, non-site specific design. Envirolok LLC makes these documents available on an "as is" basis. All CAD (.dwg) and PDF (.pdf) files were created as a service to our customers. Final determination of the suitability of any information or material for the use contemplated, and its manner of use, is the sole responsibility of the user. A final project specific design should be prepared by a qualified, licensed, professional engineer. THIS DRAWING IS NOT FOR CONSTRUCTION. Copyright: 2013, Envirolok LLC

PROJECT ENVIROLOK INSTALLATION; GEOGRID PLACEMENT; CONCAVE CURVE	
DATE JANUARY 2013	SCALE 1/4" = 1'-0"
SHEET SHEET 37	

EnvirolokTM
Vegetated Environmental Solutions

10101 N. Casey Road Evansville, WI 53536
www.envirolok.com ecosolutions@envirolok.com
P. 608.223.3571 F. 608.884.4640

REVISIONS

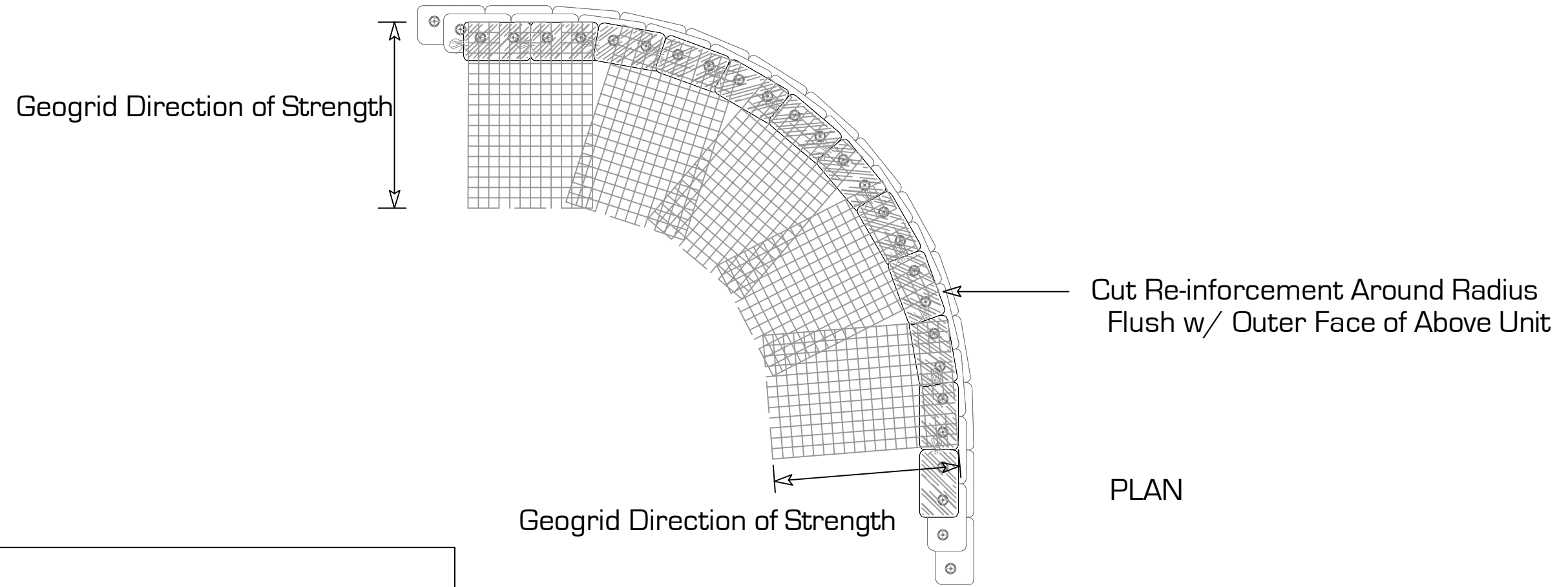

NOTE;

- * Follow Geogrid Manufacturer's Instructions for Re-inforcement Placement at Curves & Corners
- * Do Not Place Overlapping Geogrid Layers Directly on Top of Each Other.
- * Place and Compact Soil Between Overlapping Re-inforcement

This is a typical, non-site specific design. Envirolok LLC makes these documents available on an "as is" basis. All CAD (.dwg) and PDF (.pdf) files were created as a service to our customers. Final determination of the suitability of any information or material for the use contemplated, and its manner of use, is the sole responsibility of the user. A final project specific design should be prepared by a qualified, licensed, professional engineer. THIS DRAWING IS NOT FOR CONSTRUCTION. Copyright 2013, Envirolok LLC

PROJECT ENVIROLOK INSTALLATION; GEOGRID PLACEMENT; CONVEX CURVE	
DATE JANUARY 2013	SCALE 1/4" = 1'-0"
SHEET SHEET 38	

EnvirolokTM
Vegetated Environmental Solutions

10101 N. Casey Road Evansville, WI 53536
www.envirolok.com ecosolutions@envirolok.com
P. 608.223.3571 F. 608.884.4640

REVISIONS